**AMS** READY

The Atlona AT-HDVS-150-RX is an HDBaseT™ scaler receiver for HDMI transmission over category cable. It receives AV signals up to 1080p/60Hz and 1920×1200 video with embedded multi-channel audio and control signals up to 230 feet (70 meters). Features include balanced analog audio de-embedding, RS-232 control, and Power over Ethernet for compatible transmitting devices. The receiver offers advanced scaling capabilities including image adjustment capability and an Auto-set feature for matching incoming signals to the display's native resolution. Designed for use with the AT-HDVS-150-TX transmitter, the transmitter/receiver pair enables auto display on/off, auto-switching, third-party control, and other features. The built-in scaler works with matrix switchers to optimize source signals with different resolutions to a display's native resolution. The AT-HDVS-RX is ideal for long distance transmission and display control in corporate or educational settings using analog and digital sources.

The HDVS-150 maintains all capabilities the HDVS series is known for and adds industry-standard Power over Ethernet for full HDBaseT certification. The HDVS-150 Series is a simple audio visual system with auto-switching for HDMI and VGA inputs, projector on/off control, analog audio de-embedding, volume control, and a scaler. Much more than an extender system, it provides a complete system for small spaces like huddle rooms and teaching spaces with 2 or 3 sources.

#### Long distance HDMI extension -

- Receives HDMI and VGA/Audio signals up to 230 ft (70m) @ 1080p over CAT6a/7 and 197 feet (60 m) @1080p over CAT5e/6
- Uses easy-to-integrate category cable for low-cost, reliable system installation

#### Scaled HDMI output and input resolution control -

- Scales output video signals up to 1080p/60Hz and 1920x1200; Set preferred input resolution from 800x600 to 1920x1200
- Assures compatibility of VGA and HDMI sources to the display's native resolution

#### RS-232 scaler control -

- Image adjustments, resolution settings, and auto-set to display's native resolution can be made from a third party control system
- Seamless integration with larger, control system-based AV systems

#### Power over Ethernet for AT-HDVS-150-TX -

- Industry standard IEEE 802.3af PoE supplied by the receiver over HDBaseT
- No local AC outlet required at the AT-HDVS-150-TX switcher; saves time and integration costs

#### Audio de-embedding -

- Provides two channel, analog audio signal on balanced captive screw connectors
- Improves AV system audio with the use of an external amplifier such as the Atlona AT-PA100-G2

#### RS-232 display control -

- Facilitates On/Off display control; Included software simplifies programming
- Eliminates need for complex control system in small AV systems

#### Field updatable firmware -

- Rear panel USB port provides an easy means for kit upgrades
- Ensures long term system return on investment

## Specifications

### Video Resolutions

IN	1080p@23/24/25/29/30/50/59/60Hz, 1080i@50/59/60Hz, 720p@25/29/30/50/59/60Hz, 576p, 576i, 480p, 480i
	1920x1200RB, 1680x1050, 1600x1200, 1600x900, 1440x900, 1400x1050, 1366x768, 1280x1024, 1280x960, 1280x800, 1280x768, 1152x864, 1024x768, 800x600, 720x400, 640x480
OUT	1080p@24/25/29/30/50/59/60Hz, 1080i@50/59/60Hz, 720p@30/50/59/60Hz
Color Space	1920x1200, 1680x1050, 1600x1200, 1400x1050, 1366x768, 1280x1024, 1280x800, 1024x768
Color Depth	RGB, YCbCr 444, YCbCr 422
	10-bit, 12-bit, 16-bit

### Audio

Formats	PCM 2Ch, LPCM 5.1, LPCM 7.1, Dolby Digital, DTS 5.1, Dolby Digital Plus, Dolby TrueHD, DTS-HD Master Audio
Sample Rate	44.1kHz, 48kHz, 96kHz, 192kHz

### Distance

HDMI	10 meters	30 feet
CAT5e/6	60 meters	197 feet
CAT6a/7	70 meters	230 feet

### Signal

Bandwidth	6.75 Gbps
CEC	No
HDCP	Compliant

### Temperature

Operating	0°C to 40°C	32°F to 104°F
Storage	-20°C to 60°C	-4°F to 140°F
Humidity	20 to 90% non-condensing	

### Power

Consumption	15W (varies per paired transmitter)
Supply	Input: AC 100-240V ~ 50/60Hz Output: DC 24V/2.7A

### Dimension

H x W x D	30 x 122 x 125 (mm)	1.18 x 4.8 x 4.92 (inch)
-----------	---------------------	--------------------------

### Weight

Device	0.31 kg	0.67 lbs
--------	---------	----------

### Certification

Unit	CE, FCC
Power Supply	CE, FCC, Level VI, RoHS, cULus, RCM, CCC

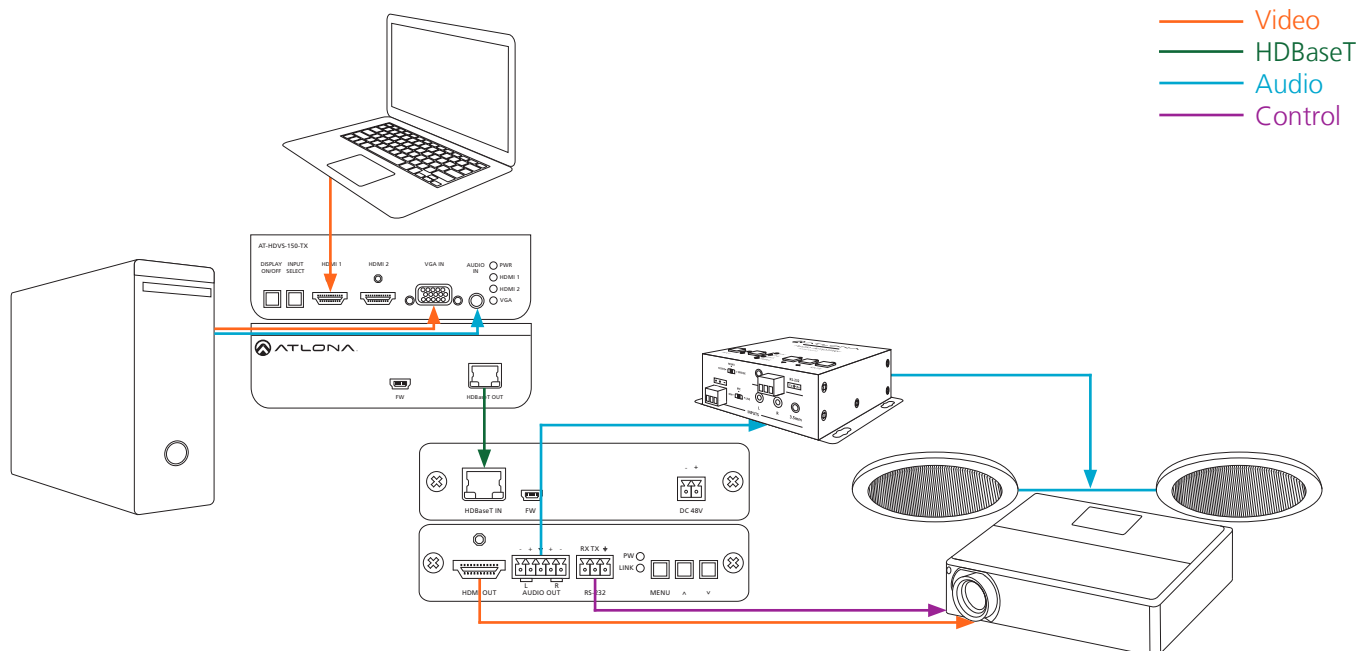

Specifications and availability subject to change without notice. Actual products, product images, and online product images may vary from images shown here. Not responsible for typographical errors.